

MMT.SE
SWEDEN | NORWAY | UK



MARINE
MAPTECH

OFFSHORE SURVEY & ROV

VESSEL | FRANKLIN



M/V FRANKLIN

SHIP DATA

LONG TERM CHARTER, OWNER:
NORTHERN SURVEY SP/F.



TYPE OF VESSEL

DP1 Survey & ROV Vessel

SPECIFICATIONS

Flag: Faroe Islands
 Port of Registry: Torshavn
 Call sign: OZ2102
 IMO No: 8301797
 Class: LR (Lloyds Register)
 Class Notation: +100A1 DP (AM), +LMC UMS

BUILDER AND DIMENSIONS

Builder: North Queensland Engineers & Agents Pty. Ltd.
 Date of build: 03.1985
 Hull No: 110
 LOA: 55 m
 Beam: 12 m
 Air Draught: 24 m
 Draft max: 4.2 m
 Req. water depth w. Azim. 6 m
 Gross tonnage: 1178t
 Net tonnage: 353t

PERFORMANCE

Service speed: 12 kts
 Max speed: 13.5 kts
 Fuel cons. (survey speed): 3 mt/day

LIMITING WEATHER CONDITIONS

Always according to Master's decision. Indicative limitations:
 Wind force 8 (Beaufort scale)
 Sea state 5 (WMO sea state code)

BUNKERS

Fuel: 198 m³
 Freshwater: 75 m³ + Evaporator

MANNING

Safe Manning Crew: 10

PROPULSION

Single Wärtsilä 12V22MD, 1590 kW at 900 rpm
 Single Lips BV CPP propeller
 Bowthruster: Retractable azimuth 295 kW, 5.3 ton
 Sternthruster: Tunnel 295 kW, 4.5 ton
 Station holding capacity: DP class 1

POWER SUPPLY

Shaft generator: 800 kVA
 Diesel generators: 2 x 375 kVA Volvo Penta D12
 415V 50 Hz 3 phase
 240V 50 Hz, UPS available

WORK SPACES

Wet lab
 Chemistry lab
 Post-processing room
 Separate client office
 General purpose lab
 Survey room

DECK EQUIPMENT

A-Frame Stern: 8 mt
 A-Frame Over the side: 2.8 mt (wire depending)
 Deck crane: 22 ton/m, winch
 SWL: 2.0 mt

FREE DECK SPACE

Approximately 85 m², 3 x 20' container
 Additional space optional

WINCHES (SWL WIRE DEPENDING):

Stern: 18 mm rotation free wire 900 m, SWL 6 mt
 10.0 mm signal FO wire 2100 m
 Side: 11.3 mm single coax 2500 m
 12.0 mm rotation free 2000 m

NAVIGATION/COMMUNICATION EQUIPMENT

Radar: Furuno 2117, Transas Naviradar 4000
 ECDIS: Transas NS 4100

GMDSS A3

V-Sat (Internet, phone)

Sat TV

Obstacle Avoidance

Sonar: Furuno

ACCOMMODATION

Cabins and beds for 10 crew and 21 special personnel (12 in single cabins, 18 in double cabins)
 Safety certificate for 33 people onboard (short trip)

Mess room
 Two Laundries
 Day room
 Hospital
 Dressing Room
 Gymnasium

EQUIPMENT



NAVIGATION AND POSITIONING

Primary Positioning System:	POS MV 320 with C-Nav C2, IALA DGPS corrections and RTK option
Secondary Positioning System:	Crescent Hemisphere with IALA DGPS corrections
Optional Positioning System:	C-Nav 3050 with C1 corrections
Optional Positioning System:	Fugro Starfix with XP/HP/G2 corrections
Gyro/Motion:	Applanix POS MV 320
Underwater positioning USBL:	iXblue GAPS
Survey Navigation System:	QPS QINSy
Sound Velocity Profiler:	Valeport MiniSVS, Valeport Midas SVX2

Hull mounted Sound

Velocity Sensor: Valeport MiniSVS

BATHYMETRY AND GEOPHYSICS

Multibeam Echo Sounder:	Kongsberg EM 2040D
Multibeam Echo Sounder:	Kongsberg EM 710
Side Scan Sonar:	Edgetech 4200MP 300/600 kHz or 300/900 kHz
Side Scan Sonar:	Edgetech 2000-CSS 300/600 kHz or 300/900 kHz
Sub-Bottom Profiler:	Kongsberg TOPAS PS40
Sub-Bottom Profiler:	Edgetech DW 106 1-10 kHz
Sub-Bottom Profiler:	Edgetech 512i 0.5-12 kHz
Sub-Bottom Profiler:	Sparker/Boomer

High resolution seismic sparker and streamers for 2D and 3D operations

Geo-Sense Multi channel Streamers 48 channels
Geo Source Sparker Systems

Magnetometer survey spread:	Towfish with TVG frame 2xMacArtney FOCUS 2 ROTV with TVG frame 2xScanFish Katria with 8 Geometrics G-882
------------------------------------	---

OFF-LINE SOFTWARE

Chesapeake SonarWiz
SMT Kingdom
Oasis Montaj incl UXO Marine
QPS/IVS Processing Suite
CARIS HIPS & SIPS
POSPac MMS
TerraPos
IXSEA DelphINS
Autodesk AutoCAD Map 3D
Arc GIS
Wish software Autochart
Visual Soft Visual Works
EIVA NaviSuite

SEAFLOOR SAMPLING AND UNDERWATER INSPECTION

ROV:	Sub-Atalantic Mohican
ROTV:	MacArtney FOCUS 2
Vibrocoring:	6/3 m system
Corers:	Piston/gravity corer 6/3 m
Samplers:	Boxcorer/grabsampler
Gradiometer:	Innovatum 12 sensor system
PCPT:	Neptune 5000
Drop Camera:	MMT HD Drop Camera



SPECIAL PURPOSE VESSEL

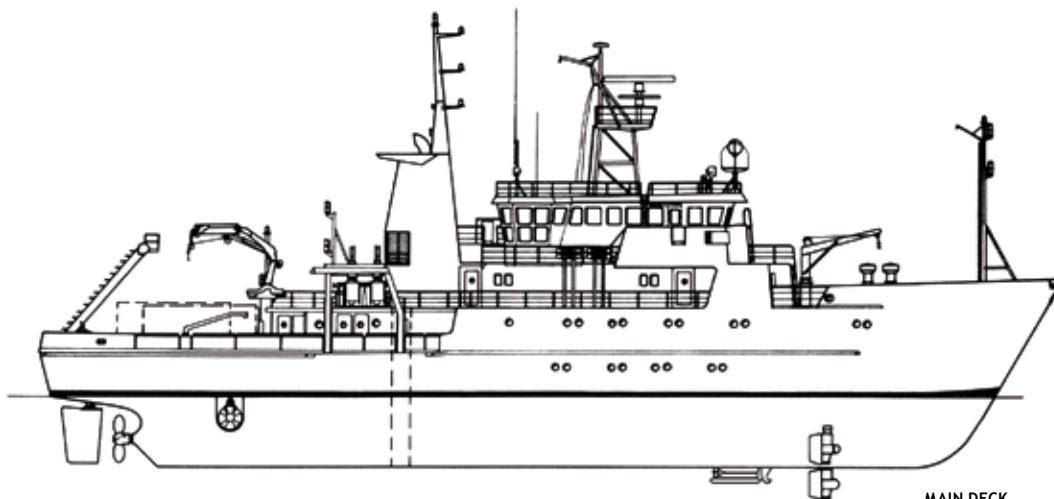

MAIN DECK

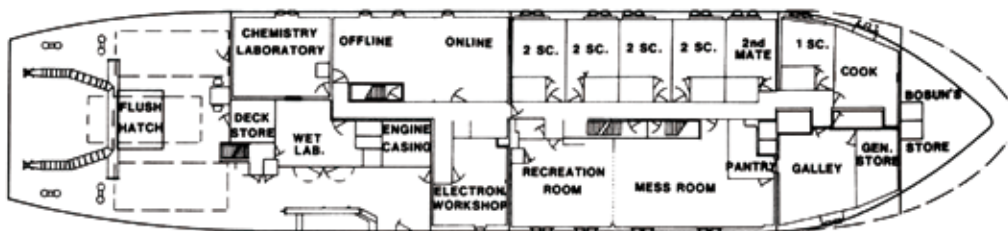

TWEEN DECK

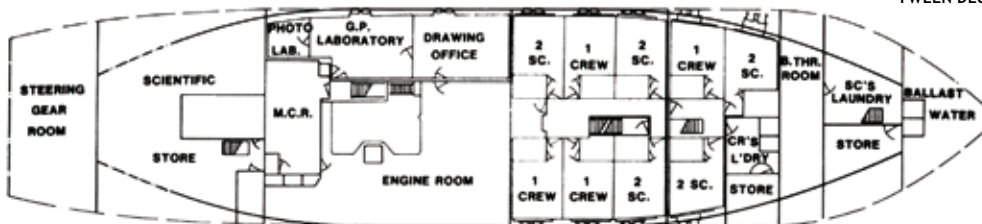

BOTTOM

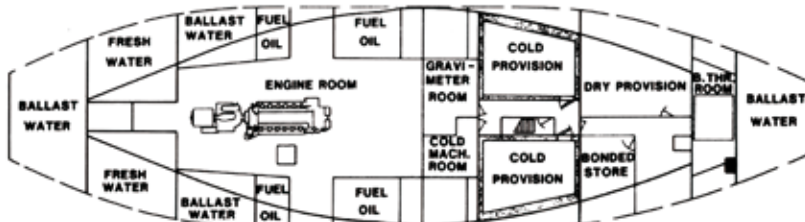

BRIDGE DECK/BOAT DECK

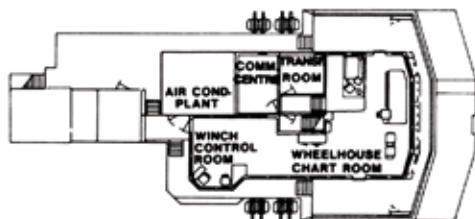

FORECASTLE DECK

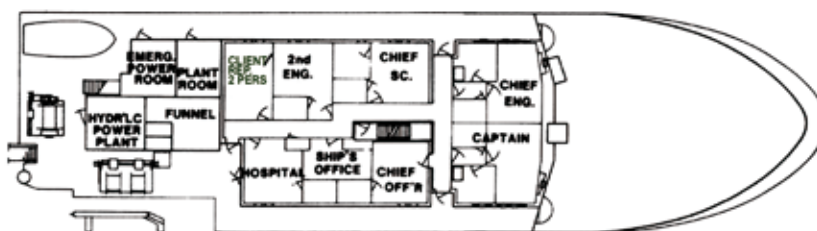

SPECIFICATIONS

Flag:
Faroe Islands

Port of Registry:
Torshavn

Call Sign:
OZ2102

IMO No:
8301797

Class:
LR (Lloyds Register)

Class Notation:
+100A1 DP (AM)
+LMC UMS